

Features & Benefits

- Pre-Galvanized Square Framework
- Easy To Assemble Interlocking Parts
- Fabric Recesses Into Framework
- Rolls Up for Easy Transport & Storage
- Also Available in Black & Construction Orange

PORTAPANEL®

Patent Pending

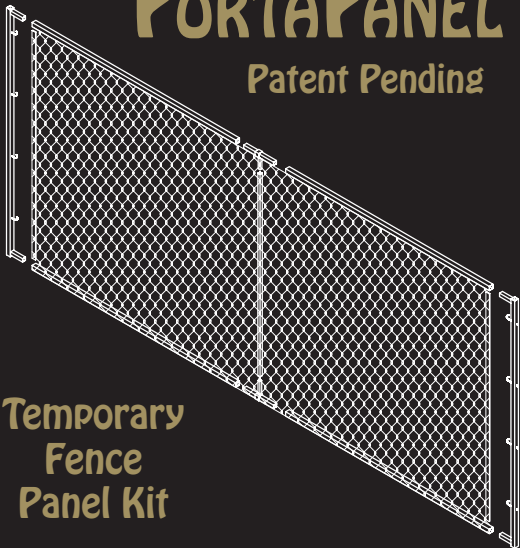

Temporary Fence Panel Kit

PORTAPANEL® Temporary Fence Panel Kit



Fence Products

1555 N. Mingo Rd. TULSA OK 74116

RETURN SERVICE REQUESTED

PORTAPANEL®
Temporary Fence Panel Kit

Attention General Contractors

Assemble free standing PortaPanels in less than 5 minutes



PortaPanels Offer Tremendous Savings

Do the Math

The average cost for a temporary chain link fence around a construction project is \$4 to \$5 per lineal foot, plus 15% more per month after 10 months, plus back charges for any damaged panels. If instead, you buy your own PortaPanel fence, shipped to you in components with very little assembly and set-up cost, you will be able to pay for it within 2 or 3 projects and you can expect more than 10 years of service from your PortaPanels.

PortaPanels will free you from paying again and again for rental fence!

Call 1-888-333-3422 To Place Your Order

PRESRT STD
US POSTAGE
PAID
TULSA, OK
PERMIT NO. 1354



from

AMERISTARFENCE.COM

The Choice of Professional Fence Installers

PORTAPANEL®

Ordering Information

Temporary Panel Kits With Fittings

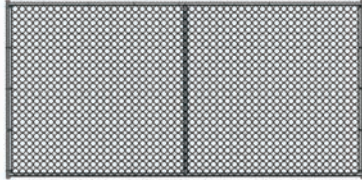

Part #	Description	Finish
PPZ0612L	6'H x 12'W - 2 3/8" x 1 1/2" Ga	Galv
PPB0612L	6'H x 12'W - 2 3/8" x 1 1/2" Ga	Black
PPO0612L	6'H x 12'W - 2 3/8" x 1 1/2" Ga	Orange

Four (4) panel minimum order.
Freight paid on pallet quantities (16 panels).

Panel Stands

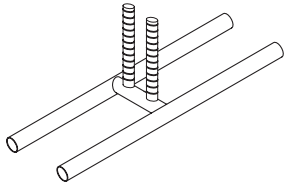

Panel Joiners

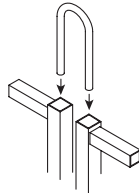

Part #	Description
PPSZR	H-Frame Tube Base w/1" Rebar

Part #	Description
PPJZR	U-Shaped Loop 5/8" Dia. Rod



Compact
KD Kits

●
One
Pallet
Equals
192' of
Fence

PortaPanels Transport Easily & Require Minimal Storage Area

Available In 3 Finishes

Economical Galvanized



Accent Black



Construction Orange



PortaPanels Make Sense

When you approach a construction site, the first thing you notice is not the heavy construction equipment or the in-process excavation activity. No! It's the worn out, over-used temporary fence panels brought to the site by the rental fence contractor.

By contrast, Ameristar's unique patent pending PortaPanel frame design utilizes the efficient shape of square steel tubes to harness the perfectly recessed chain link fabric. This smooth, protrusion-free profile is a vast improvement in appearance over tired-looking rental panels. If that's not enough, PortaPanels are not only available in the standard galvanized finish, but also in polymer-coated accent black and construction orange.

The convenience of owning your PortaPanel perimeter fence offers huge advantages over renting temporary fence. With PortaPanels, you don't have to wait for delivery from an outside rental service. Moreover, you can control the set-up schedule and secure large jobsites quickly. When job size is small or location is distant, you can avoid excessive trip charges. When a project is finished, you can move them to the next jobsite, without having to pay back damage charges.

PORTAPANEL®

Temporary Fence Panel Kits

Call Toll Free: 1-888-333-3422
or Visit Our Website at
www.clPortaPanel.com